



Document Title:
Hot-Line Y-Y Clevis 26 in. 50,000 lbs.

Document Type:
Equipment Specification

Document No.:
4752.299

Department:
Transmission Engineering

Version:
00

Effective Date:
Jun 8, 2023

Shared document with: T&S T&D T&TM D&TM

Author

Bárbara Ventura Riera
Technical Specialist, T&S Standards and Materials

Signature and Date

Bárbara Ventura Riera
Bárbara Ventura Riera (May 24, 2023 10:00 EDT)

Reviewer

Leonardo Montes
Engineer in Training, T&S Standards and Materials

Signature and Date

LMA
Leonardo Montes Sanchez (May 24, 2023 11:13 EDT)

Approver

René Maldonado, P.E. (Lic. #18435)
Supervisor, Line Engineering Standards

Signature and Date

Ré Maldonado
Rene Maldonado (Jun 8, 2023 08:00 EDT)

Version History

Version	Date	Revision Comments
00	Jun 8, 2023	First Issue



1.0 General

- 1.1. This is a general specification that covers the minimum requirements for a Hot Line Y-Y Clevis 26 in. to be used in the transmission system in Puerto Rico.
- 1.2. Further information will be provided by LUMA Energy at the time of order placement and will provide information on site conditions, quantity, and other requirements.
- 1.3. This document includes the general electrical and mechanical characteristics of the material.

2.0 Specific Name

- 2.1. Hot Line Y-Y Clevis 26 in. 50,000 lbs.

3.0 Basic Use

- 3.1. Used to connect associated hardware within an insulator string or connecting deadend clamps to yoke plates providing clearances for jumper ends.

4.0 Special Requirements

- 4.1. Samples shall be furnished if requested by LUMA.
- 4.2. LUMA may require one (1) unit properly labeled for testing and/or analysis.

4.3. Quantity

- 4.3.1. Descriptive and technical literature shall be supplied if requested by LUMA, with respect to products described in this specification as requiring qualification, awards will be made only for such products that have, prior to the time act for opening of bids, been tested and/or approved by LUMA. Evidence of LUMA'S approval of the equipment or material shall be supplied by vendor if requested by LUMA.

4.4. Marking and Packaging

- 4.4.1. Containers shall be marked outside with LUMA'S purchase order number and code number. Vendors shall prepare material and equipment for shipment in such a manner as to facilitate handling and protection from damage. All material should be packaged and marked in such a way that the receiving warehouse can readily identify and send in one (1) complete unit to a field location without opening crates or boxes to sort items and / or parts.

5.0 Number per Package

- 5.1. Pallet quantity as requested by LUMA.

6.0 Acceptance Criteria

- 6.1. The material shall be designed, manufactured, and tested in accordance with the latest applicable ANSI, and ASTM Standards. If the vendor does not demonstrate its compliance with the applicable standards, these specification requirements and supply the requested documents, the bid may be rejected.



6.2. Drawings:

6.2.1. The vendor shall submit drawings for all accessories being furnished unless previously furnished to the company and approved.

6.2.2. The drawings shall include the following information, but not limited to:

- Dimension and tolerances
- Accessory Weight
- Catalog Number
- Installation Instructions

7.0 Description

7.1. The body shall be ductile iron material.

7.2. Body, hardware, bolts, and nut shall be hot dip galvanized as per ASTM 153.

7.3. The cotter pin shall be stainless steel.

7.4. The length (L) for this material shall be 26 inches.

7.5. Bent bolt diameter for this material shall be approximately 0.88 inches.

7.6. Rated holding strength shall be 50,000 lbs.

7.7. Metric conversion as per latest ASTM.

8.0 Equal or Approved Equal

8.1. Hubbell – Catalog No. FHYYC5026

9.0 Inspection

9.1. The acceptance of any material or equipment shall in no way relieve the vendor from his responsibility to meet all the requirements of this specification, and it shall not prevent subsequent rejection if such material is found to be defective later.

10.0 Drawing

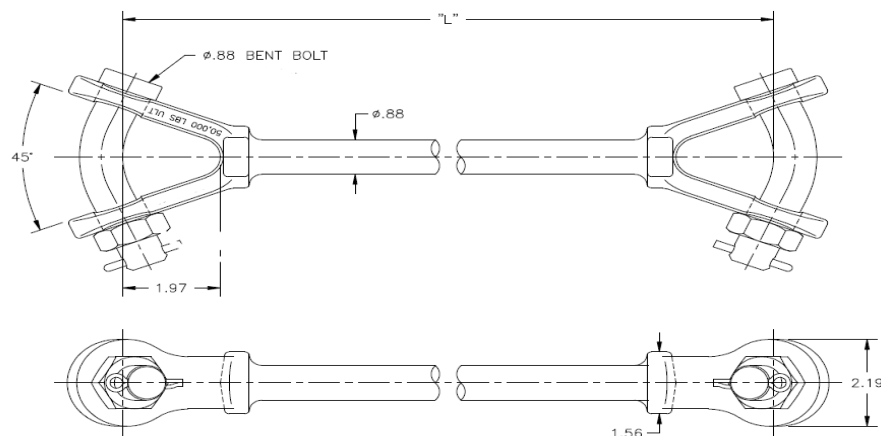

— End of Specification —









4752.299 Hot-Line Y-Y Clevis 26 in. 50,000 lbs.

Final Audit Report

2023-06-08

Created:	2023-05-24
By:	Bárbara Ventura Riera (Barbara.Ventura@Lumapr.com)
Status:	Signed
Transaction ID:	CBJCHBCAABAAAtDZhBWoKkRwbmk3DMB0M3rg9ZjJWv9Gu

"4752.299 Hot-Line Y-Y Clevis 26 in. 50,000 lbs." History

-  Document created by Barbara Ventura (Barbara.Ventura@Lumapr.com)
2023-05-24 - 1:54:40 PM GMT
-  Signer Barbara Ventura (Barbara.Ventura@Lumapr.com) entered name at signing as Bárbara Ventura Riera
2023-05-24 - 2:00:12 PM GMT
-  Document e-signed by Bárbara Ventura Riera (Barbara.Ventura@Lumapr.com)
Signature Date: 2023-05-24 - 2:00:14 PM GMT - Time Source: server
-  Document emailed to Leonardo Montes Sanchez (leonardo.montessanch@lumapr.com) for signature
2023-05-24 - 2:00:15 PM GMT
-  Document e-signed by Leonardo Montes Sanchez (leonardo.montessanch@lumapr.com)
E-signature obtained using URL retrieved through the Adobe Acrobat Sign API
Signature Date: 2023-05-24 - 3:13:49 PM GMT - Time Source: server
-  Document emailed to Rene Maldonado (rene.maldonado@lumapr.com) for signature
2023-05-24 - 3:13:50 PM GMT
-  Email viewed by Rene Maldonado (rene.maldonado@lumapr.com)
2023-06-08 - 12:00:06 PM GMT
-  Document e-signed by Rene Maldonado (rene.maldonado@lumapr.com)
Signature Date: 2023-06-08 - 12:00:22 PM GMT - Time Source: server
-  Agreement completed.
2023-06-08 - 12:00:22 PM GMT