



Anchor Shackle 35,000 lbs

Equipment Specification

Document No.: 4752.184

Item No.: 002-13959

Originating Dept: Transmission Eng



Document Title:

Anchor Shackle 35,000 lbs

Document Type:

Equipment Specification

Document No.:

4752.184

Department:

Transmission Engineering

Version:

01

Issue Date:

5/17/2022

Effective Date:

5/17/2022

Author

Emmanuel E Rivera Cruz
Designer, Transmission & Substation Engineering

Signature and Date

Emmanuel E Rivera Cruz (May 31, 2022 14:27 EDT)

Reviewer 1

Rene Maldonado
Supervisor, Line Engineering Standards

Signature and Date

Rene Maldonado (Jun 1, 2022 09:45 EDT)

Reviewer 2

Oscar Venegas
Lead Engineer, Trans

Signature and Date

Oscar E Venegas (Jun 6, 2022 09:20 EDT)

Approver

Walter Carrasquillo Alberty
Manager, T&S Standards and Materials

Signature and Date

Walter Carrasquillo (Jun 6, 2022 14:34 EDT)

Management Approval

Heriberto González
Section Manager, Standards

Signature and Date

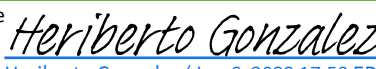
Heriberto Gonzalez (Jun 6, 2022 17:58 EDT)

Darrel Wilvers
Director, Asset Management

Signature and Date

N/A

Version History

Version	Date	Revision Comments	Author	Reviewers	Approver
00	Dec 28, 2021		Rene Maldonado	Heriberto Gonzalez	Walter Carrasquillo
01	May 17, 2022	General revision for final approval	Emmanuel E. Rivera	Rene Maldonado Oscar Venegas	Walter Carrasquillo



1. General

- 1.1. This is a general specification that covers the minimum requirements for an anchor shackle to be used in the transmission system in Puerto Rico.
- 1.2. Further information will be provided by LUMA Energy at the time of order placement and will provide information on site conditions, quantity, and other requirements.
- 1.3. This document includes the general electrical and mechanical characteristics of the material.

2. Specific Name

- 2.1. Anchor Shackle 35,000lbs.

3. Basic Use

- 3.1. For attach the overhead ground wire clamp assembly and insulator assembly in transmission structures.

4. Special Requirements

- 4.1. Samples shall be furnished if requested by LUMA.
- 4.2. LUMA may require one (1) unit properly labeled for testing and analysis.
- 4.3. Descriptive and technical literature shall be supplied if requested by LUMA.

5. Marking and Packaging

- 5.1. All material and equipment shall be packaged and marked in such a way as to facilitate handling and protection from damage and that the receiving warehouse can readily identify it and send it, in one complete unit, to a field location without opening crates or boxes to sort items and/or parts.

6. Equal or approved equal to:

- 6.1. Hubble catalog No. AS35

7. Number per package:

- 7.1. Pallet quantity: 1600 or as required by LUMA.

8. Acceptance Criteria

- 8.1. Latest applicable codes, standards, and other regulations: ANSI/ASTM.

9. Description

- 9.1. Anchor shackle used to attach the overhead ground wire hardware and conductors insulators for tangent and deadend line configuration.
- 9.2. Anchor shackle shall be made from drop-forged steel with an ultimate strength of 35,000LBF minimum.



- 9.3. Shall be hot-dip galvanized in accordance with ANSI/ASTM A153.
- 9.4. Metric conversion as per latest ASTM.

10. Inspection

- 10.1. The acceptance of any material or equipment shall in no way relieve the vendor from his responsibility to meet all the requirements of this specification, and it shall not prevent subsequent rejection if such material is found to be defective later.

11. Drawing

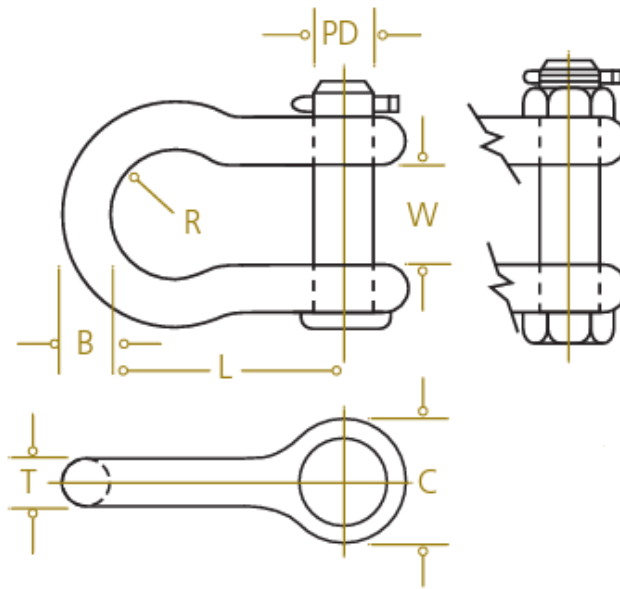

L Min.	B Min.	T Dia.	C Min.	W Min.	R Min.	PD
2 ²⁵ / ₃₂ "	¹¹ / ₁₆ "	⁵ / ₈ "	1 ¹¹ / ₁₆ "	1 ¹ / ₁₆ "	³ / ₄ "	³ / ₄ "

— End of Specification —